

Your **Rivarossi** 0-4-0 STEAM SWITCHER has been carefully assembled and tested prior to leaving the factory. It will provide virtually maintenance-free service; however, normal wear from extended usage will necessitate occasional replacement of motor brushes and traction tires. LUBRICATION AND REPLACEMENT OF BRUSHES AND TIRES CAN BE ACCOMPLISHED WITHOUT NEED FOR MAJOR DISASSEMBLY OF THE CHASSIS nor will it be necessary to uncouple the loco and tender.

© 1970, ATLAS TOOL CO., INC.

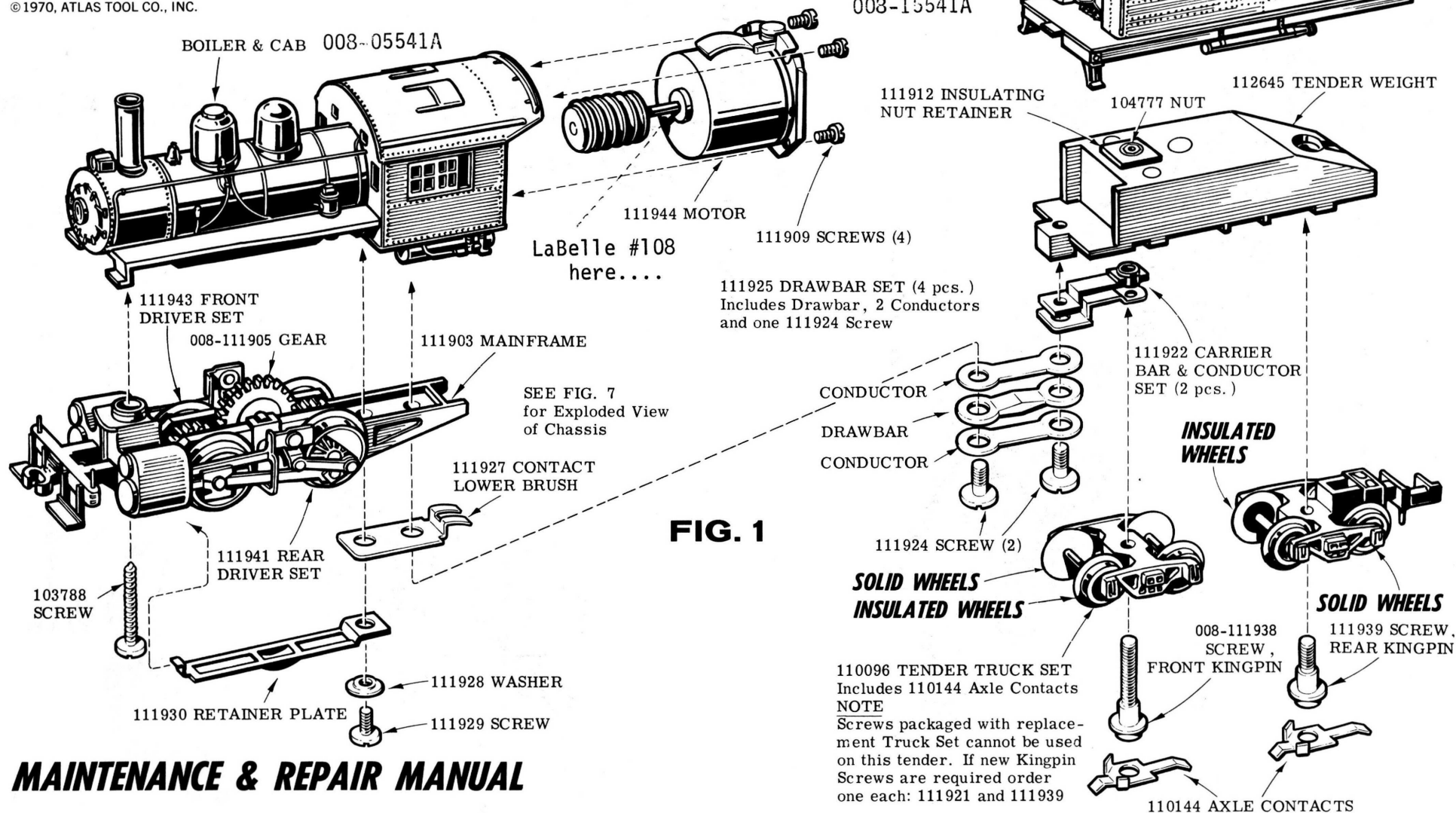

MAINTENANCE & REPAIR MANUAL



0-4-0 Steam Locomotive

111903 MAINFRAME ASSEMBLY

Factory assembly includes:

Frame
Cylinder Block
Crosshead Guides
Swinging Links
Eccentric Rods
Eccentric Cranks
Wheel Wiper Contacts

111916 GEAR, 23 tooth

TO BOTTOM OF CAB

NOTE: Dockside Locomotive Has Same Parts

CHASSIS DISASSEMBLY

Major chassis disassembly will rarely be necessary and IS NOT RECOMMENDED for the novice. The correct procedure for dismantling the chassis is as follows.

A. Uncouple tender by removing Screw 111924 from engine. Drawbar elements should remain fixed to tender.

B. Using a jeweler's screwdriver (preferably magnetized) remove Crankpin Screws 110269 then lift eccentric cranks and mainrods from crankpin.

C. Remove Boiler Mounting Screw 103788 and Retainer Plate Screw 111929 and Washer 111928. Boiler can now be removed and chassis elements fully disassembled.

CHASSIS REASSEMBLY

A. Install Gear 111916 in Mainframe 111903 as shown in FIGS. 1 & 7. IMPORTANT! One side of gear is relieved (dished) slightly. This side must be installed toward the left side of the mainframe.

B. Position boiler atop mainframe and secure with Screw 103788.

C. Install the drivewheel sets placing the drivers with crankpins in rear slot. The drivers may be installed without concern for an insulated side; both sides being alike.

D. Place Contact Plate 111927 in position with its two fingers toward mainframe as shown.

E. Make certain crankpin bosses and counterweights point same way on both drivewheel sets then install Retainer Plate 111930. Lip at front of retainer plate hooks over small flange extending from rear of cylinder block. Replace Washer 111928 and Screw 111929. NOTE: Slightly bumped up center portion of washer should face retainer plate.

F. Drop ends of mainrods over crankpins on rear drivers then secure eccentric cranks with Crankpin Screws 110269. Before tightening the crankpin screws position the eccentric cranks as shown in FIG. 8 at the right.

G. Recouple tender to engine with Screw 111924.

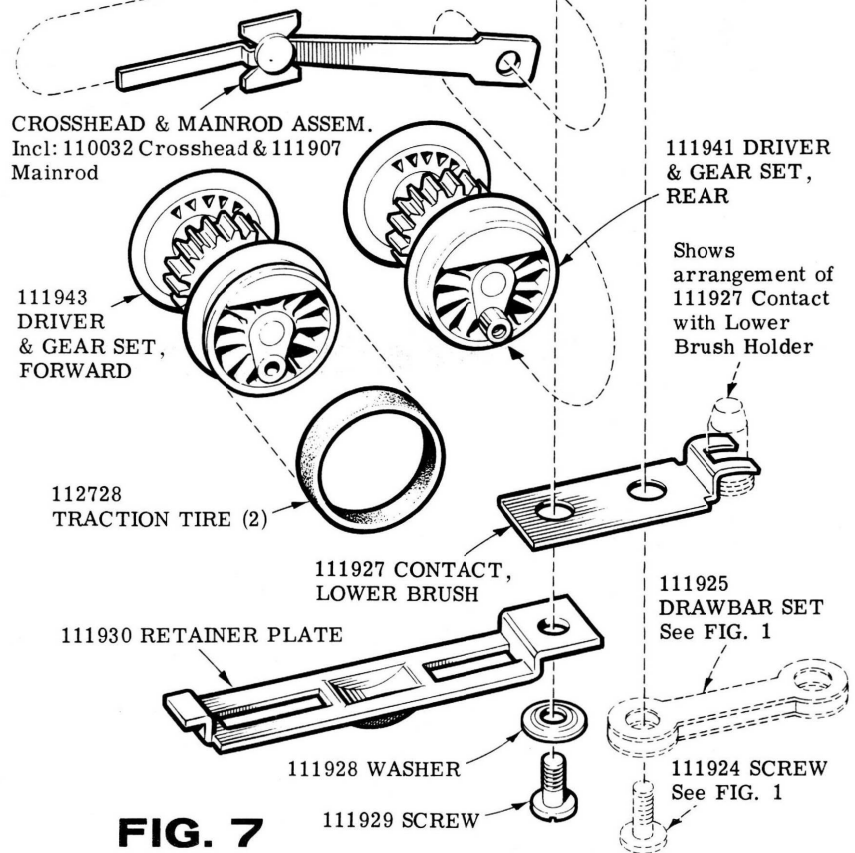

FIG. 7
CHASSIS ASSEMBLY EXPLODED

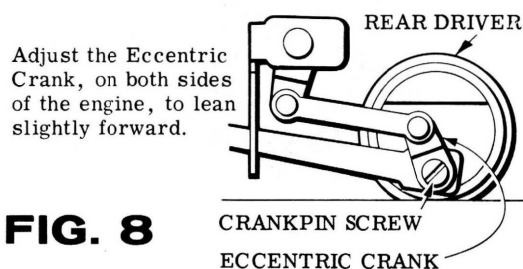

FIG. 8